

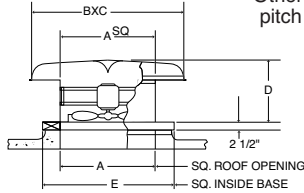

- Standard props are heavy gauge steel.
- Aluminum propellers with static free belts for ex. proof
- Used for exhaust or supply applications.
- Heavy industrial steel base with aluminum hood.
- Bird screen included at top of housing.
- Self aligning pillow block bearings with locking collars.
- Industrial quality motor, factory assembled, tested and adjusted, ready to install.
- Roof curbs: flat, single slope or ridge, back draft damper optional.
- Other accessories or options: filters, protective coatings, variable pitch pulleys (consult factory).



### Dimensions

FAN SIZE	A	BxC	D	E
24	30	54x64	30	39
30	36	60x76	36	45
36	42	72x82	40	51
42	48	80x89	43	57
48	54	87x95	46	63
54	60	90x108	54	69
60	66	92x120	56	75

### Ordering Summary

1-PHASE		3-PHASE		FAN SIZE	MOTOR HP	FAN RPM	CFM-STATIC PRESSURE				SHIP WT. (LBS.)	LIST			
115/230V	230/460V	0"	1/8"				1/4"	3/8"	EXHAUST			INTAKE			
MODEL NO.	MODEL NO.	SIZE	HP	RPM	0"	1/8"	1/4"	3/8"	(LBS.)	1PH.	3PH.	1PH.	3PH.		
HVD24141	HVD24143	24	1/4	780	4222	2807	1576	800	171	•	•	•	•		
HVD24121	HVD24123	24	1/2	980	5716	5061	4043	2600	180	•	•	•	•		
HVD24341	HVD24343	24	3/4	1140	6648	6144	5518	4413	189	•	•	•	•		
HVD2411	HVD2413	24	1	1250	6696	6271	5600	4464	243	•	•	•	•		
HVD30131	HVD30133	30	1/3	595	6380	3617	1808	767	229	•	•	•	•		
HVD3121	HVD30123	30	1/2	640	7170	4486	2724	1373	238	•	•	•	•		
HVD3034	HVD30343	30	3/4	770	9192	7657	5108	3833	243	•	•	•	•		
HVD3011	HVD3013	30	1	975	9959	8626	6828	5184	252	•	•	•	•		
HVD301121	HVD301123	30	1 1/2	1140	11112	9656	8135	5539	261	•	•	•	•		
HVD36131	HVD36133	36	1/3	460	6992	3722	1825	496	274	•	•	•	•		
HVD36121	HVD36123	36	1/2	530	8821	5985	3642	2084	279	•	•	•	•		
HVD36341	HVD36343	36	3/4	605	10583	8563	5545	4170	283	•	•	•	•		
HVD3611	HVD3613	36	1	665	11932	10099	7913	5729	292	•	•	•	•		
HVD361121	HVD361123	36	1 1/2	720	12012	10519	7743	5800	301	•	•	•	•		
HVD3621	HVD3623	36	2	870	14088	11942	9691	6388	315	•	•	•	•		
HVD42121	HVD42123	42	1/2	390	9352	4957	3050	1642	369	•	•	•	•		
HVD42341	HVD42343	42	3/4	435	11530	7633	4847	3311	373	•	•	•	•		
HVD4211	HVD4213	42	1	490	13194	10438	6414	4668	378	•	•	•	•		
HVD421121	HVD421123	42	1 1/2	550	15921	13117	9980	7289	387	•	•	•	•		
HVD4221	HVD4223	42	2	725	19128	17503	15264	11319	405	•	•	•	•		
—	HVD4233	42	3	830	20984	19406	17290	11498	423	—	•	—	•		
HVD48341	HVD48343	48	3/4	370	13700	7389	4280	2244	495	•	•	•	•		
HVD4811	HVD4813	48	1	410	16078	10903	6378	4037	504	•	•	•	•		
HVD481121	HVD481123	48	1 1/2	465	19010	14991	10950	7081	508	•	•	•	•		
HVD4821	HVD4823	48	2	550	21993	19080	15532	10125	513	•	•	•	•		
—	HVD4833	48	3	680	23615	20820	16930	12400	531	—	•	—	•		
—	HVD4853	48	5	800	29290	27380	25000	18590	540	—	•	—	•		
HVD5411	HVD5413	54	1	410	20588	17500	11640	9600	562	•	•	•	•		
HVD541121	HVD541123	54	1 1/2	450	22600	19300	12780	10316	567	•	•	•	•		
HVD5421	HVD5423	54	2	480	24312	20660	13642	11010	585	•	•	•	•		
—	HVD5433	54	3	500	25880	21730	15420	11600	590	—	•	—	•		
—	HVD5453	54	5	660	32891	30208	26518	17400	603	—	•	—	•		
HVD6011	HVD6013	60	1	250	19161	12850	—	—	603	•	•	•	•		
HVD601121	HVD601123	60	1 1/2	340	23203	15624	11434	8000	612	•	•	•	•		
HVD6021	HVD6023	60	2	390	26710	17724	13118	9380	621	•	•	•	•		
—	HVD6033	60	3	450	32256	25224	18705	15013	639	—	•	—	•		
—	HVD6053	60	5	540	35819	29000	23237	17000	670	—	•	—	•		
—	HVD6073	60	7	620	43981	40350	32887	24500	750	—	•	—	•		

NOTE: When ordering, add suffixes as follows:  
Exhaust = E; Intake = I

All units are made to order and are not returnable.